

RICON® 140/40



Pfosten-Riegelverbindung
mit Bauzulassung (DE+EU)
post and latch connection

with construction supervisory approval (DE+EU)

<p>RICON 140/40</p>	<p>RICON SK Scr 8x80</p>	<p>RICON ISK M 8x25, M8x20</p>	
	<p>RICON SK Scr 8x50</p>	<p>Verbundmutter/ connecting nut M8x36,48,53, 58, 68, 78</p>	
	<p>RICON SK Scr 5x80</p>	<p>RICON Einschraub- mutter / insert M8x18</p>	
	<p>RICON SK Scr 5x50</p>	<p>RICON Sperrbügel / stirrup</p>	

Einzel und Doppelanschluss
single and double connection

Pfosten-Riegelverbindung
latch and post connection

Riegel Fräsbild /
Milled edge latch

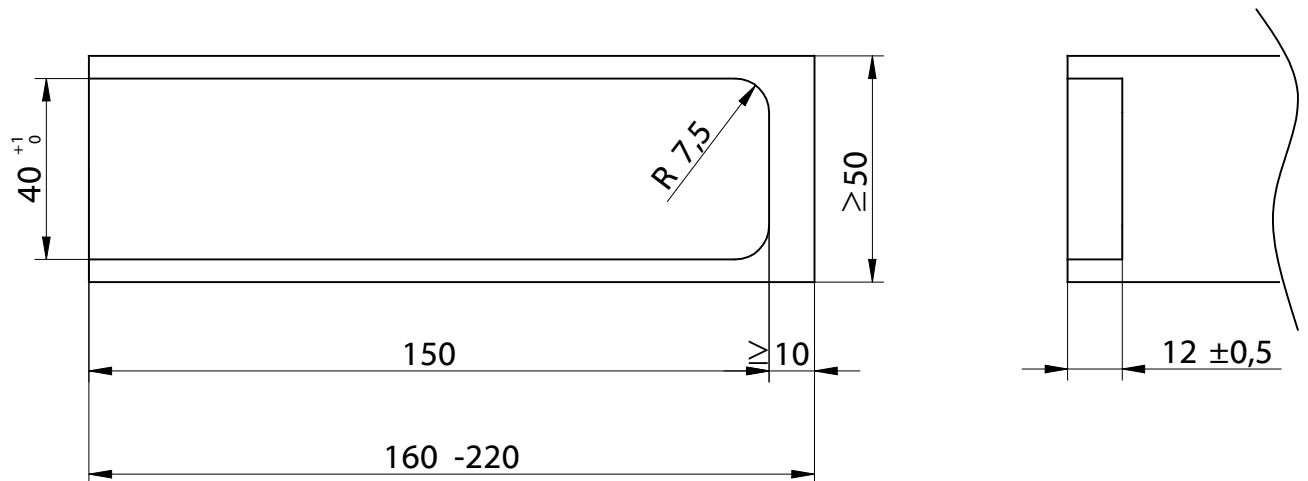

© KNAPP GmbH. Alle Maße in mm - Irrtümer, Druckfehler und Änderungen vorbehalten / all measures in mm - Errors excepted. VERSION 03 20.08.2010

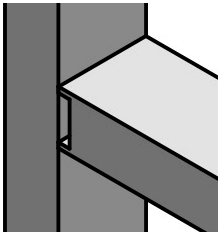

Montageanleitung/Construction Manual

RICON® 140/40 EA

Art. Nr. K365

Einzelanschluss
single connection

Pfosten-Riegelverbindung
latch and post connection

Bohrbild im Riegel /
drilling template for latch

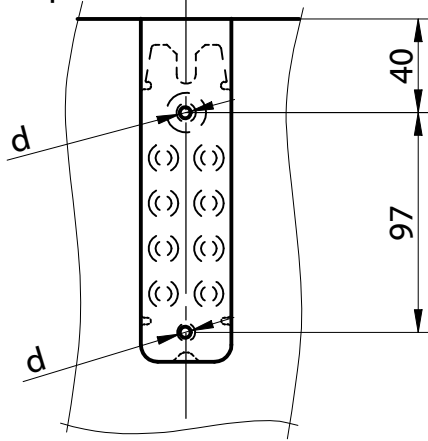

d...Ø 5mm, 30mm tief vorbohren
d...Ø 5mm, 30mm deep predrilling

Bohrbild im Pfosten /
drilling template for post

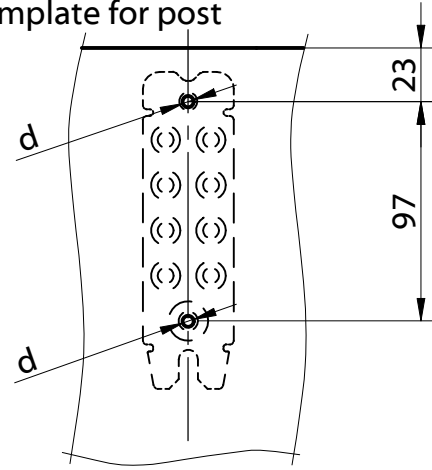

d...Ø 5mm, 30mm tief vorbohren
d...Ø 5mm, 30mm deep predrilling

Schraubenbild im Riegel /
screw template for latch

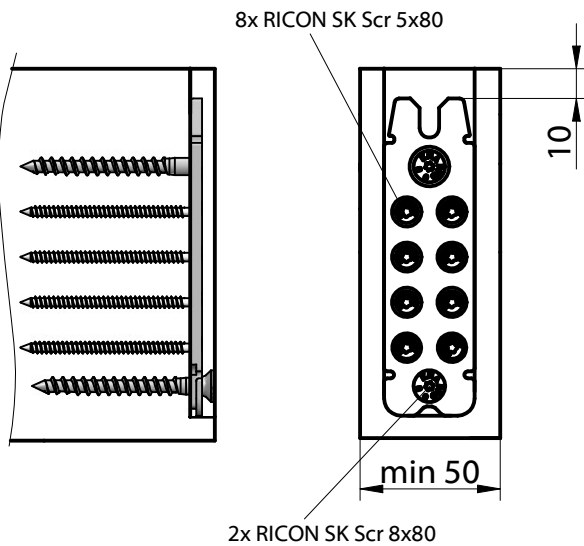

Schraubenbild im Pfosten /
screw template for post

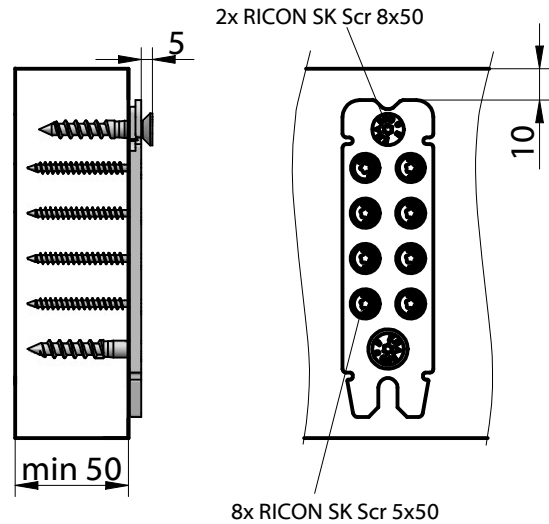

Einstellen der Schraube /
screw position adjustment

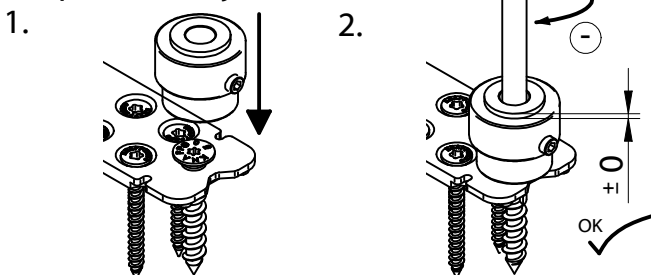

Sperrbügel einlegen /
assemble stirrup

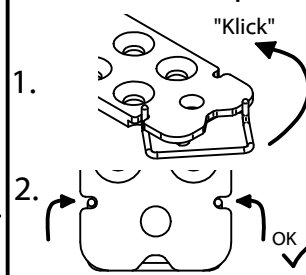

Sperrbügel lösen /
remove stirrup

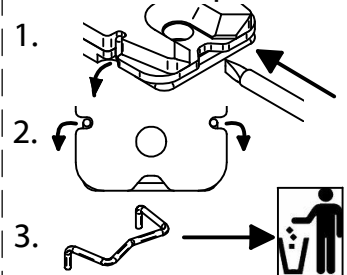

© KNAPP GmbH. Alle Maße in mm - Irrtümer, Druckfehler und Änderungen vorbehalten / all measures in mm - Errors excepted. VERSION 03 20.08.2010

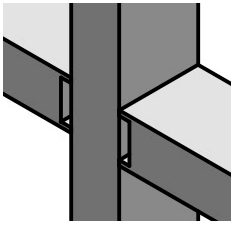

RICON® 140/40 DA

Art. Nr. K165/48;
K165/58; K165/78

Doppelanschluss
double connection

Pfosten-Riegelverbindung
latch and post connection

Bohrbild im Riegel /
drilling template for latch

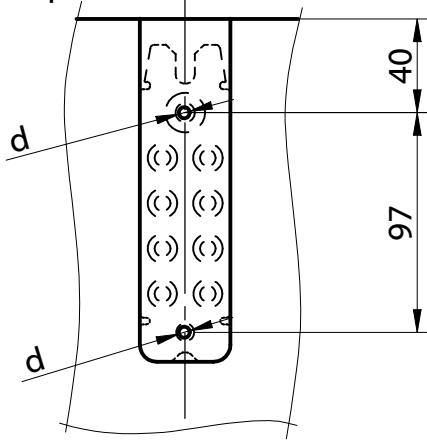

d...Ø 5mm, 30mm tief vorbohren
d...Ø 5mm, 30mm deep predrilling

Bohrbild im Pfosten /
drilling template for post

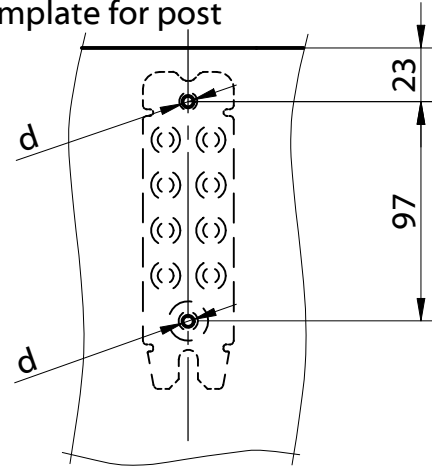

d...Ø 10mm, Durchgangsloch
d...Ø 10mm, throughhole

Schraubenbild im Riegel /
screw template for latch

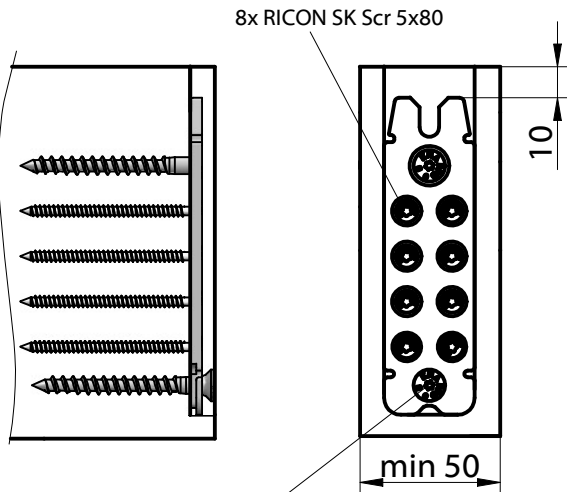

2x RICON SK Scr 8x80

Schraubenbild im Pfosten /
screw template for post

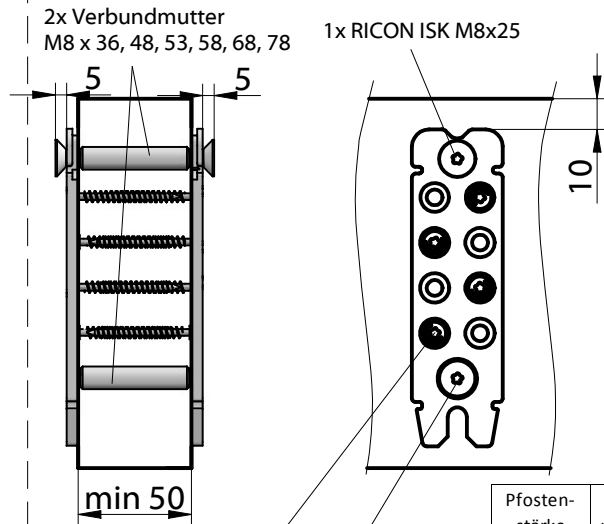

2x Verbundmutter
M8 x 36, 48, 53, 58, 68, 78

1x RICON ISK M8x25

4x RICON SK Scr 5x50
wechselseitig
1x RICON ISK M8x25

Pfosten- stärke [mm]	Verbund- mutterlänge [mm]
50	48
56	53
60	58
80	78

Einstellen der Schraube /
screw position adjustment

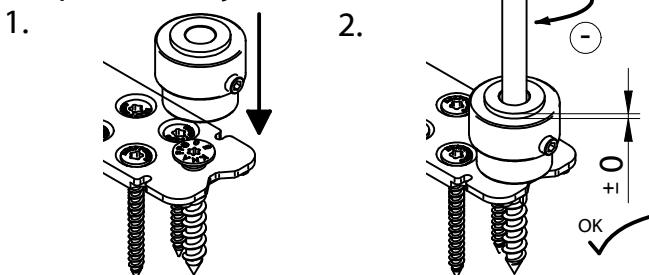

Sperrbügel einlegen /
assemble stirrup

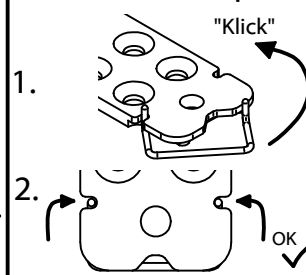

Sperrbügel lösen /
remove stirrup

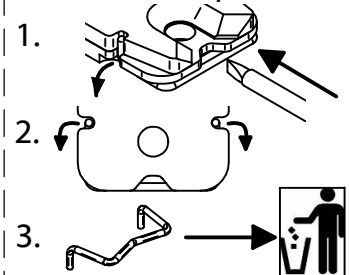

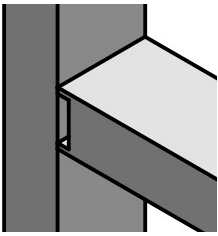

Montageanleitung/Construction Manual

RICON® 140/40 EAR

Art. Nr. K265 Einzelanschluss mit Einschraubmutter
single connection with insert screw

Pfosten-Riegelverbindung
post and latch connection

Bohrbild im Riegel /
drilling template for latch

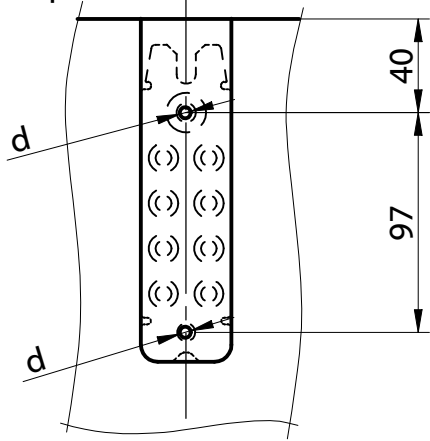

d...Ø 5mm, 30mm tief vorbohren
d...Ø 5mm, 30mm deep predrilling

Bohrbild im Pfosten /
drilling template for post

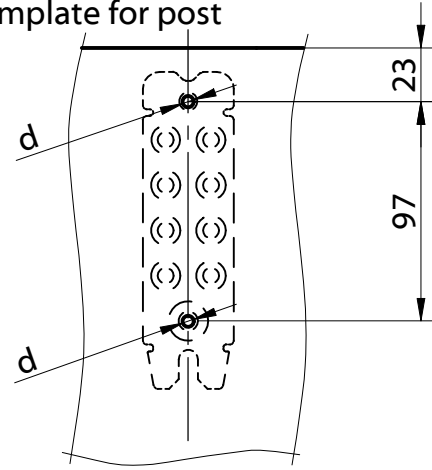

d...Ø 12 mm, 20 mm tief vorbohren
d...Ø 12 mm, 20mm deep predrilling

Schraubenbild im Riegel /
screw template for latch

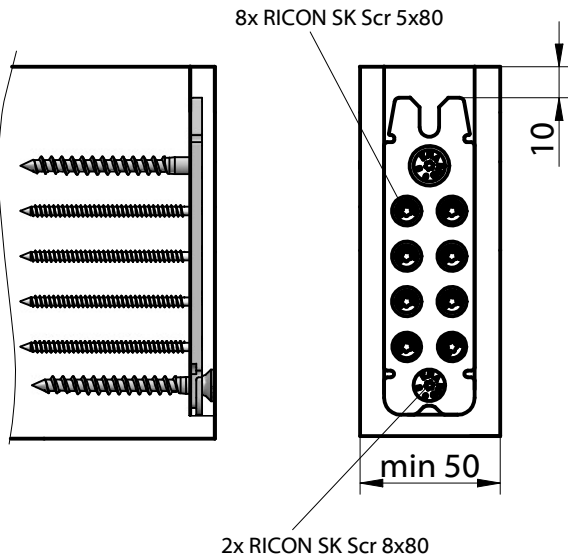

2x RICON SK Scr 8x80

Schraubenbild im Pfosten /
screw template for post

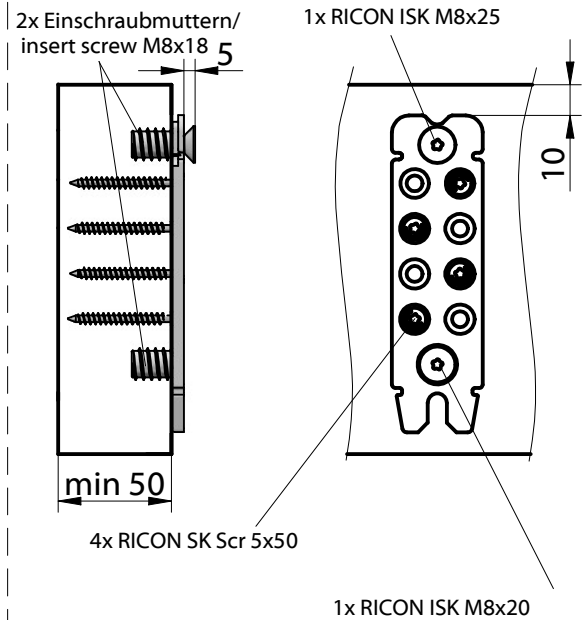

1x RICON ISK M8x20

Einstellen der Schraube /
screw position adjustment

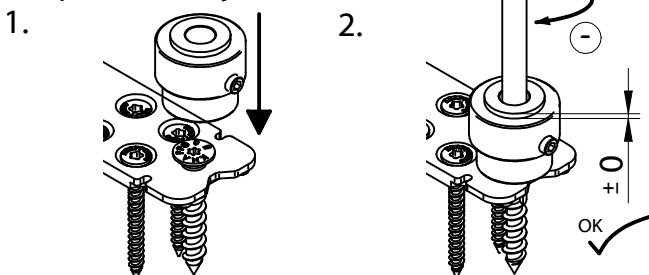

Sperrbügel einlegen /
assemble stirrup

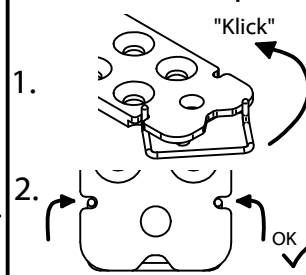

Sperrbügel lösen /
remove stirrup

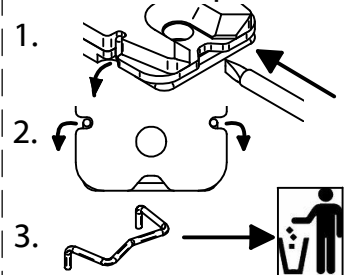

© KNAPP GmbH. Alle Maße in mm - Irrtümer, Druckfehler und Änderungen vorbehalten / all measures in mm - Errors excepted. VERSION 03 20.08.2010

RICON® 140/40



Haupt- Nebenträgerverbindung

mit Bauzulassung (DE + EU)

main girder- joist connection

with construction supervisory approval (DE + EU)

RICON 140/40

RICON SK Scr 8x80

RICON SK Scr 8x50

RICON SK Scr 5x80

RICON SK Scr 5x50

RICON Sperrbügel / stirrup

RICON ISK M 8x25, M8x20

Verbundmutter/
connecting nut
M8x36,48,53, 58, 68, 78

RICON Einschraub-
mutter / insert M8x18

Einzel- und Doppelanschluss
single and double connection

Haupt-Nebenträgerverbindung
main girder - joist connection

Hauptträger Fräsbild /Milled edge main girder

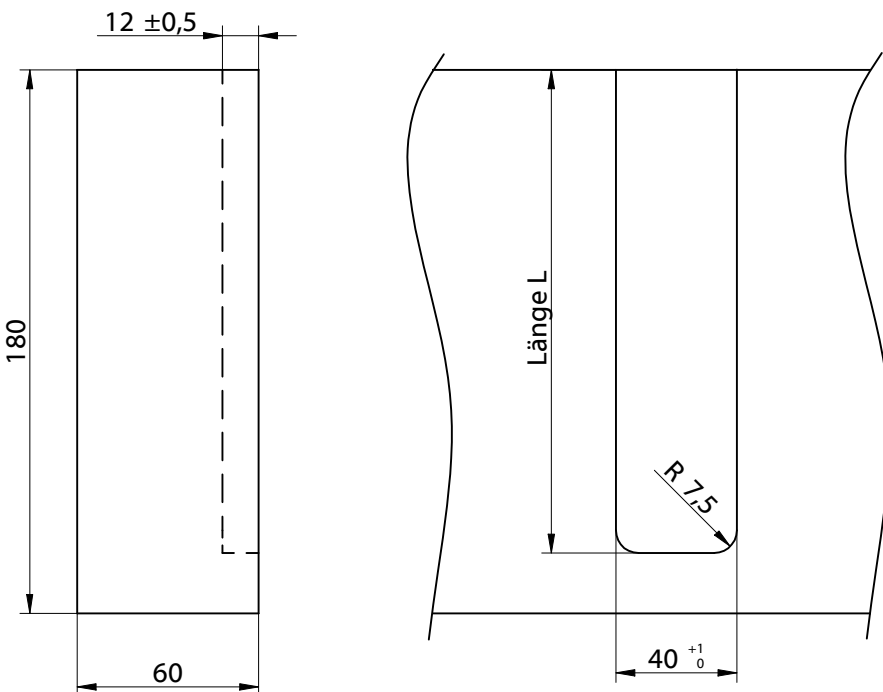

Ausfräslänge L aus dem Hauptträger in Abhängigkeit der Nebenträgerhöhe HN /
Rebate length for main girder in reference of the height HN of the joist:

Höhe / Height HN [mm]	Länge/ Length L [mm]
180	160
200	170
220	180
240	200
260	210

© KNAPP GmbH. Alle Maße in mm - Irrtümer, Druckfehler und Änderungen vorbehalten / all measures in mm - Errors excepted. VERSION 03 20.08.2010

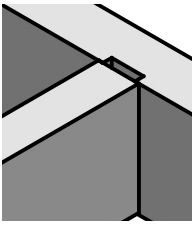

Montageanleitung/Construction Manual RICON® 140/40 EA

Art. Nr. K365

Einzelanschluss
single connection

Haupt-Nebenträger Verbindung
main girder - joist connection

Bohrbild im Hauptträger /
drilling template for main girder

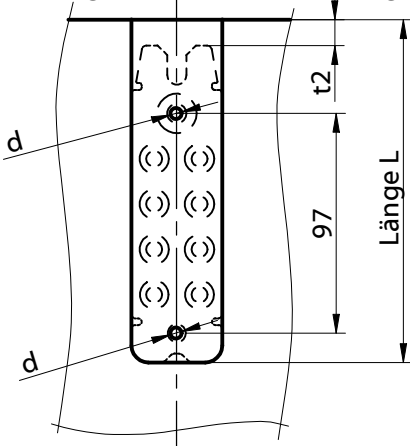

d...Ø 5mm, 30mm tief vorbohren
d...Ø 5mm, 30mm deep predrilling

Bohrbild im Nebenträger /
drilling template for joist

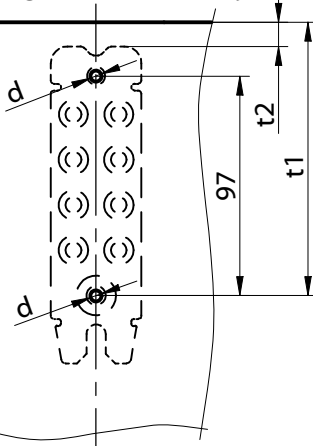

d...Ø 5mm, 30mm tief vorbohren
d...Ø 5mm, 30mm deep predrilling

Einbohrmaße t1 und Abstandsmaß t2 in
Abhängigkeit der Nebenträgerhöhe HN/
Bore measure t1 and distance t2 for joist in
reference to the height HN of the joist

Höhe / Height HN [mm]	Abstand/ Distance t1 [mm]	Abstand/ Distance t2 [mm]
180	130	20
200	140	30
220	150	40
240	170	60
260	180	70

Schraubenbild im Hauptträger /
screw template for main girder

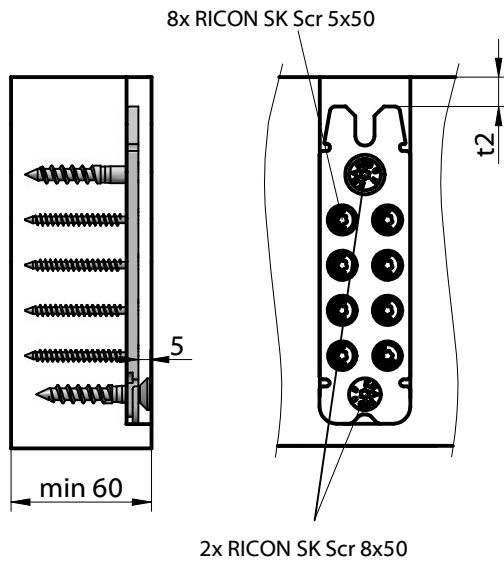

Schraubenbild im Nebenträger /
screw template for joist

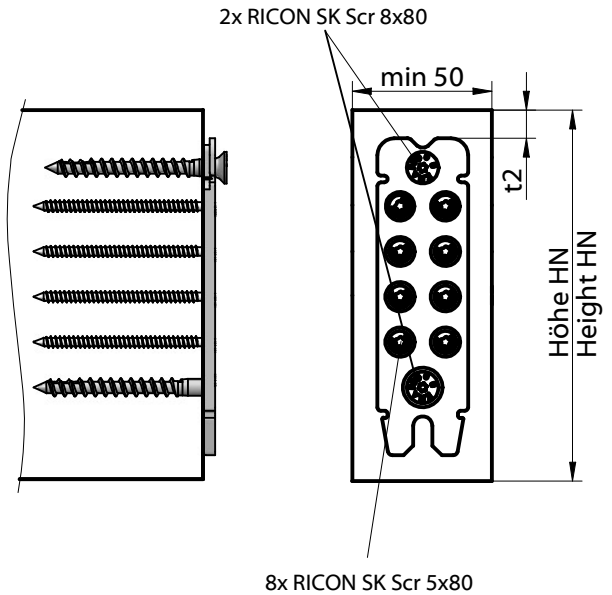

Einstellen der Schraube /
screw position adjustment

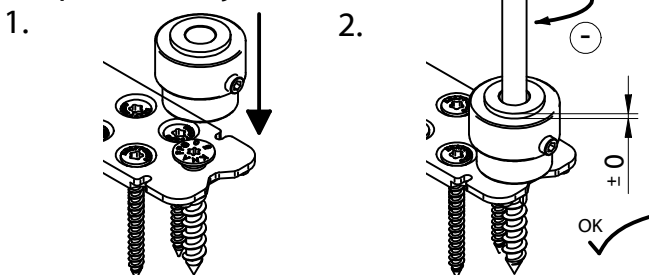

Sperrbügel einlegen /
assemble stirrup

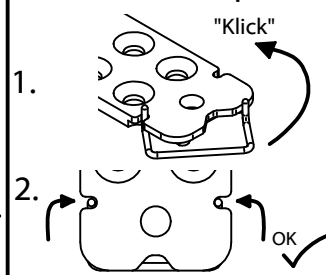

Sperrbügel lösen /
remove stirrup

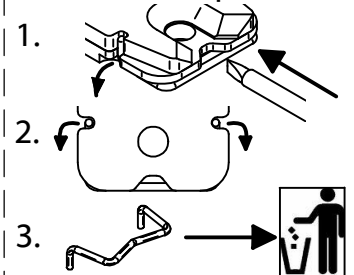

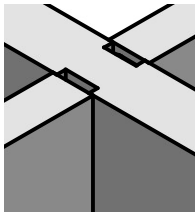

Montageanleitung/Construction Manual

RICON® 140/40 DA

Art. Nr. K165/48;
K165/58; K165/78

Doppelanschluss
double connection

Haupt-Nebenträger Verbindung
main girder - joist connection

Bohrbild im Hauptträger / drilling template for main girder

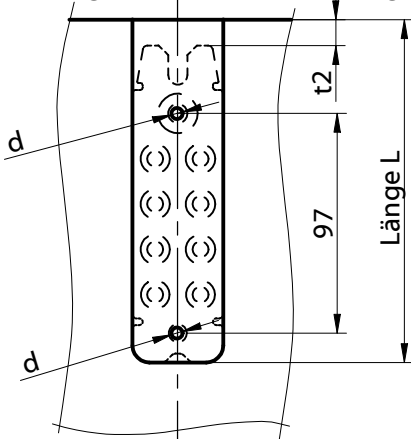

d...Ø 10mm, Durchgangsloch
d...Ø 10mm, throughhole

Bohrbild im Nebenträger / drilling template for joist

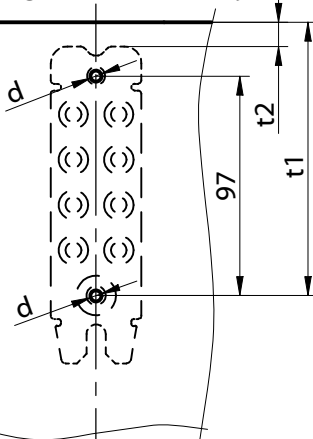

d...Ø 5mm, 30mm tief vorbohren
d...Ø 5mm, 30mm deep predrilling

Einbohrmaße t1 und Abstandsmaß t2 in
Abhängigkeit der Nebenträgerhöhe HN/
Bore measure t1 and distance t2 for joist in
reference to the height HN of the joist

Höhe / Height HN [mm]	Abstand/ Distance t1 [mm]	Abstand/ Distance t2 [mm]
180	130	20
200	140	30
220	150	40
240	170	60
260	180	70

Schraubenbild im Hauptträger / screw template for main girder

2x Verbundmutter
M8 x 36, 48, 53, 58, 68, 78

1x RICON ISK M8x25

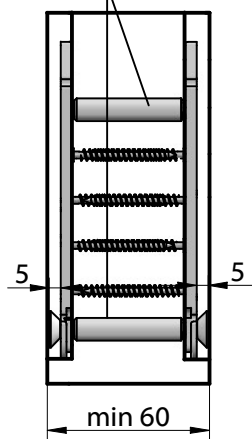

4x RICON SK Scr 5x50
wechselseitig
1x RICON ISK M8x25

Hauptträger- stärke [mm]	Verbund- mutterlänge [mm]
60	36
80	53

Schraubenbild im Nebenträger / screw template for joist

2x RICON SK Scr 8x80

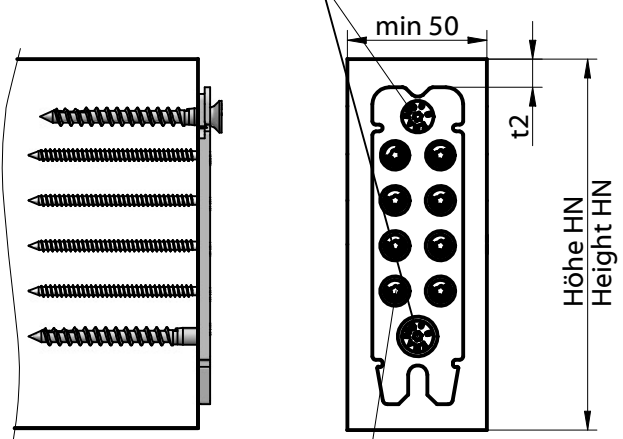

8x RICON SK Scr 5x80

Einstellen der Schraube / screw position adjustment

1.

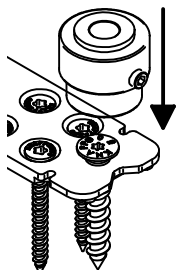

2.

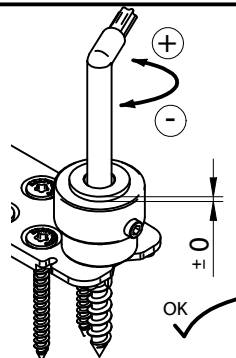

Sperrbügel einlegen / assemble stirrup

1.

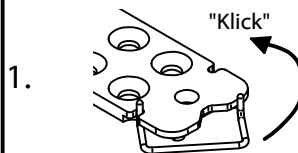

2.

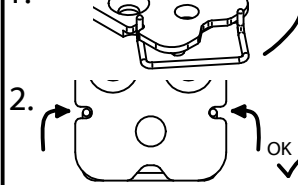

Sperrbügel lösen / remove stirrup

1.

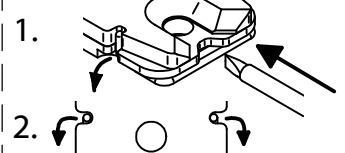

2.

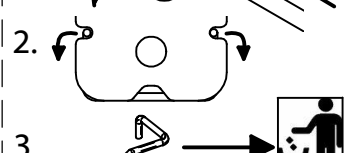

3.



© KNAPP GmbH. Alle Maße in mm - Irrtümer, Druckfehler und Änderungen vorbehalten / all measures in mm - Errors excepted. VERSION 03 20.08.2010

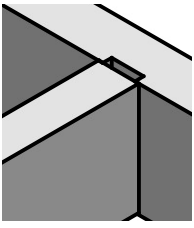

Montageanleitung/Construction Manual

RICON® 140/40 EAR

Art. Nr. K265

Einzelanschluss mit Einschraubmutter
single connection with insert screw

Haupt-Nebenträger Verbindung
main girder - joist connection

Bohrbild im Hauptträger /
drilling template for main girder

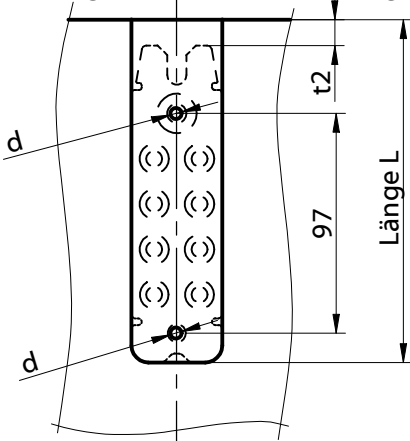

d...Ø 12 mm, 20 mm tief vorbohren
d...Ø 12 mm, 20 mm deep predrilling

Bohrbild im Nebenträger /
drilling template for joist

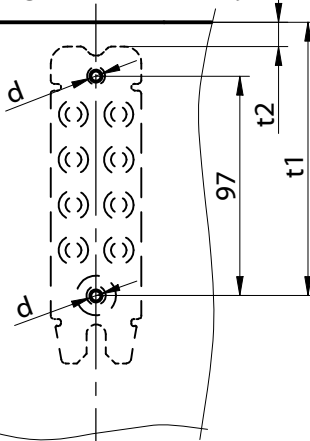

d...Ø 5 mm, 30mm tief vorbohren
d...Ø 5 mm, 30mm deep predrilling

Einbohrmaße t1 und Abstandsmaß t2 in
Abhängigkeit der Nebenträgerhöhe HN/
Bore measure t1 and distance t2 for joist in
reference to the height HN of the joist

Höhe / Height HN [mm]	Abstand/ Distance t1 [mm]	Abstand/ Distance t2 [mm]
180	130	20
200	140	30
220	150	40
240	170	60
260	180	70

Schraubenbild im Hauptträger /
screw template for main girder

2x Einschraubmutter/
insert screw M8x18

1x RICON ISK M8x20

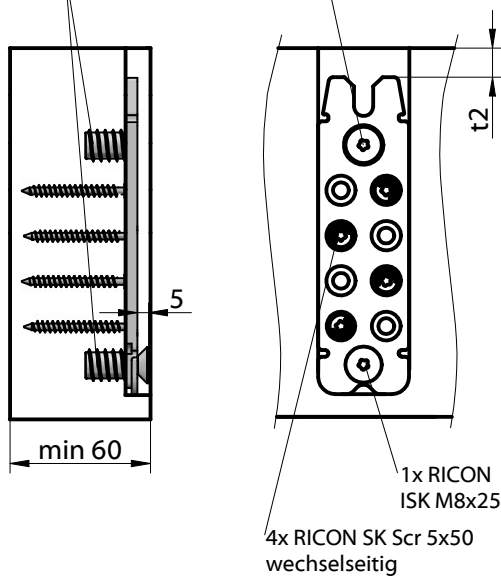

Schraubenbild im Nebenträger /
screw template for joist

2x RICON SK Scr 8x80

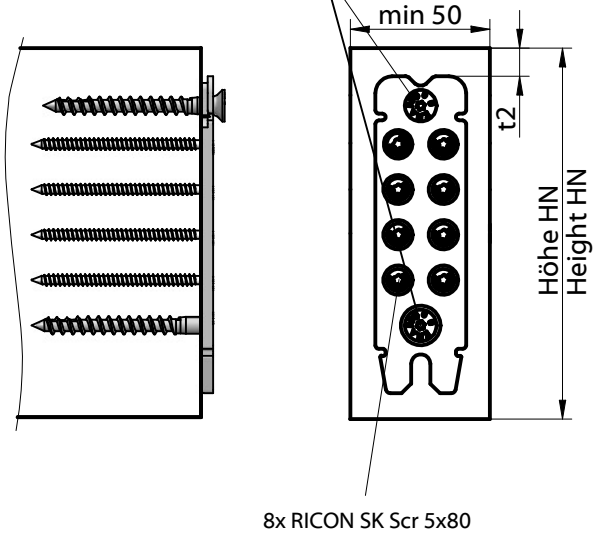

Einstellen der Schraube /
screw position adjustment

1.

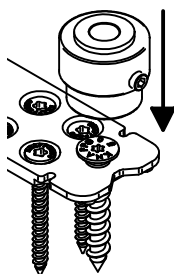

2.

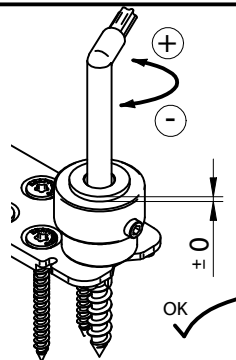

Sperrbügel einlegen /
assemble stirrup

1.

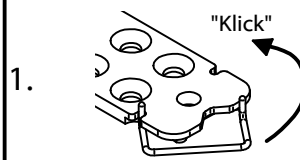

2.

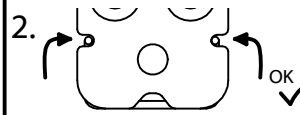

Sperrbügel lösen /
remove stirrup

1.

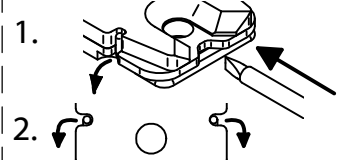

2.



3.

