

RICON® 60/40



Pfosten-Riegelverbindung
mit Bauzulassung (DE+EU)
post and latch connection

with construction supervisory approval (DE+EU)

<p>RICON 60/40</p>	<p>RICON SK Scr 8x80 </p> <p>RICON SK Scr 8x50 </p> <p>RICON SK Scr 5x80 </p> <p>RICON SK Scr 5x50 </p> <p>RICON Sperrbügel / stirrup </p>	<p>RICON ISK M 8x25, M8x20 </p> <p>RICON ISK M5x20 </p> <p>Verbundmutter / connecting nut M8x48, 53, 58, 78 M5x48, 53, 58, 78</p> <p></p> <p>RICON Einschraubmutter / insert M8x18</p> <p>RICON Einschraubmutter / insert M5x14</p>
---------------------------	---	--

Einzel und Doppelanschluss
single and double connection

Pfosten-Riegelverbindung
latch and post connection

Riegel Fräsbild /
Milled edge latch

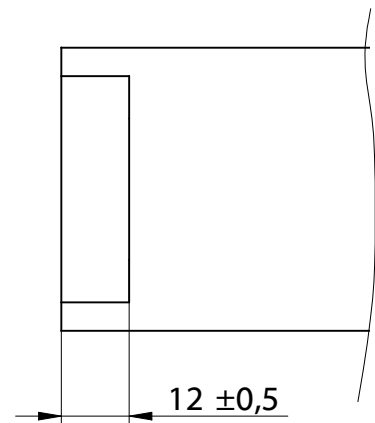
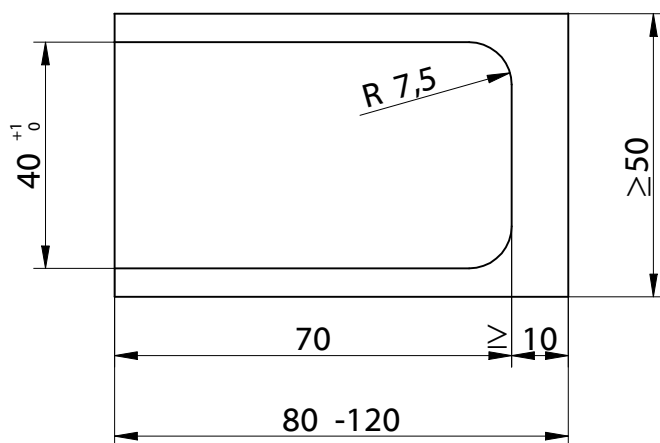

© KNAPP GmbH. Alle Maße in mm - Irrtümer, Druckfehler und Änderungen vorbehalten / all measures in mm - Errors excepted. VERSION 03 20.08.2010

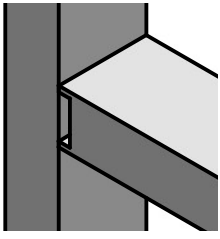

Montageanleitung/Construction Manual

RICON® 60/40 EA

Art. Nr. K360

**Einzelanschluss
single connection**

**Pfosten-Riegelverbindung
latch and post connection**

Bohrbild im Riegel /
drilling template for latch

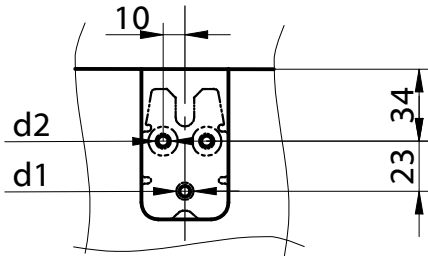

d1...Ø 5mm, 30mm tief vorbohren
d1...Ø 5mm, 30mm deep predrilling

d2...Ø 5mm, 10mm tief vorbohren
d2...Ø 5mm, 10mm deep predrilling

Bohrbild im Pfosten /
drilling template for post

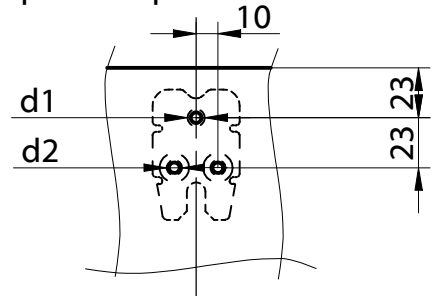

d1...Ø 5mm, 30mm tief vorbohren
d1...Ø 5mm, 30mm deep predrilling

d2...Ø 5mm, 10mm tief vorbohren
d2...Ø 5mm, 10mm deep predrilling

Schraubenbild im Riegel /
screw template for latch

2x RICON SK Scr 5x80

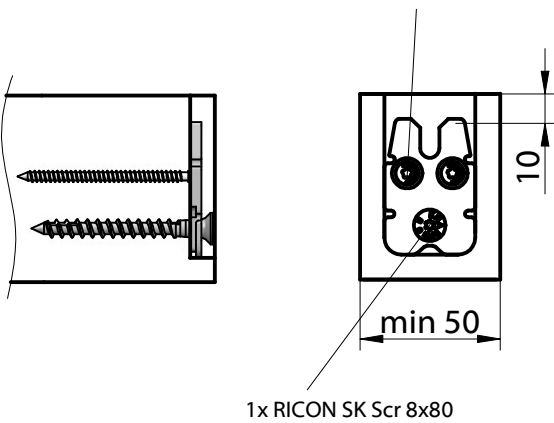

1x RICON SK Scr 8x80

Schraubenbild im Pfosten /
screw template for post

1x RICON SK Scr 8x50

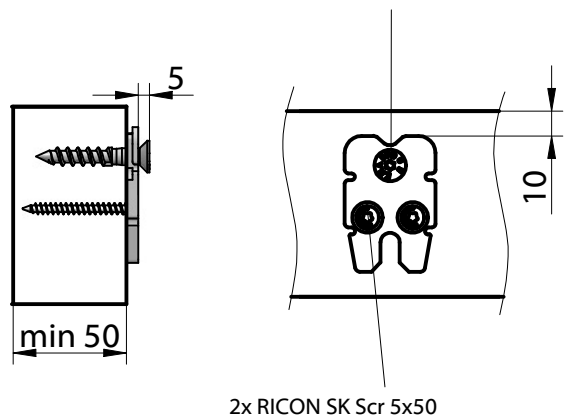

2x RICON SK Scr 5x50

Einstellen der Schraube /
screw position adjustment

1.

2.

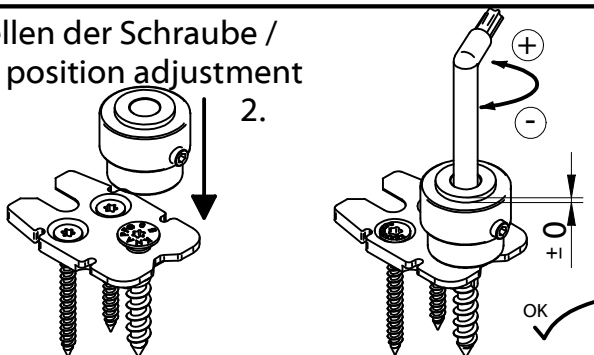

Sperrbügel einlegen /
assemble stirrup

1.

2.

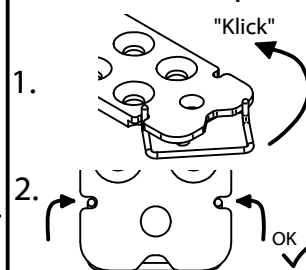

Sperrbügel lösen /
remove stirrup

1.

2.

3.

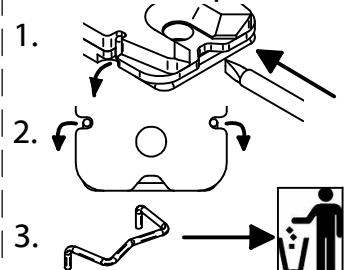

© KNAPP GmbH. Alle Maße in mm - Irrtümer, Druckfehler und Änderungen vorbehalten / all measures in mm - Errors excepted. VERSION 03 20.08.2010

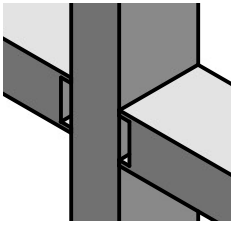

RICON® 60/40 DA

Art. Nr. K160/48;
K160/58; K160/78

Doppelanschluss
double connection

Pfosten-Riegelverbindung
latch and post connection

Bohrbild im Riegel /
drilling template for latch

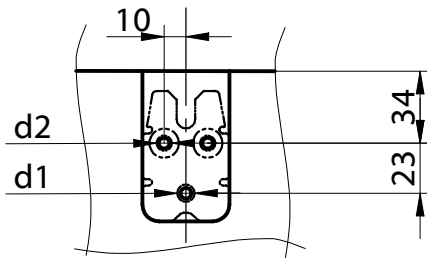

d1...Ø 5mm, 30mm tief vorbohren
d1...Ø 5mm, 30mm deep predrilling

d2...Ø 5mm, 10mm tief vorbohren
d2...Ø 5mm, 10mm deep predrilling

Bohrbild im Pfosten /
drilling template for post

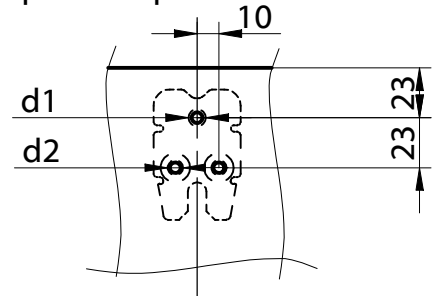

d1...Ø 10mm, Durchgangsloch
d1...Ø 10mm, throughhole

d2...Ø 8mm, Durchgangsloch
d2...Ø 8mm, throughhole

Schraubenbild im Riegel /
screw template for latch

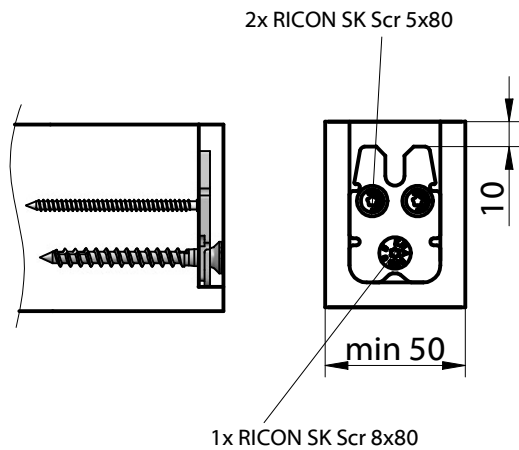

2x RICON SK Scr 5x80

1x RICON SK Scr 8x80

Schraubenbild im Pfosten /
screw template for post

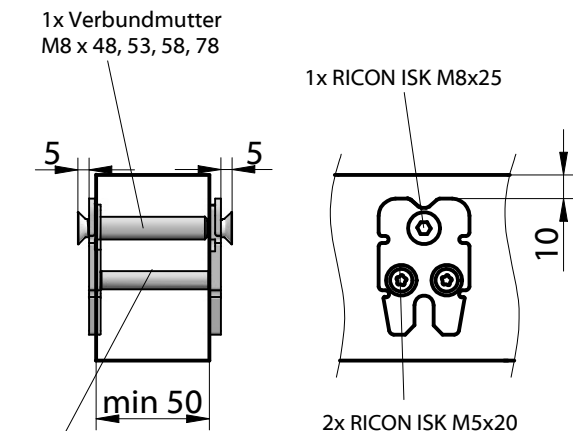

1x Verbundmutter
M8 x 48, 53, 58, 78

1x RICON ISK M8x25

2x Verbundmutter
M5 x 48, 53, 58, 78

2x RICON ISK M5x20

Pfosten- stärke [mm]	Verbund- mutterlänge [mm]
50	48
56	53
60	58
80	78

Einstellen der Schraube /
screw position adjustment

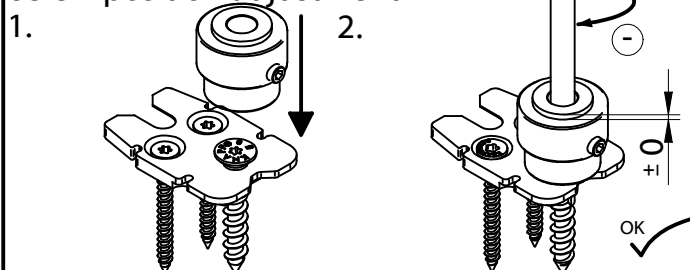

Sperrbügel einlegen /
assemble stirrup

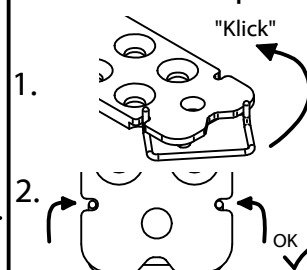

Sperrbügel lösen /
remove stirrup

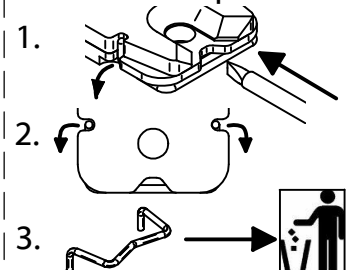

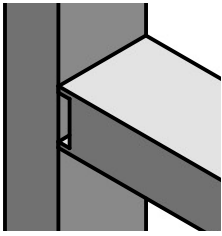

Montageanleitung/Construction Manual

RICON® 60/40 EAR

Art. Nr. K260 Einzelanschluss mit Einschraubmutter
single connection with insert screw

Pfosten-Riegelverbindung
post and latch connection

Bohrbild im Riegel /
drilling template for latch

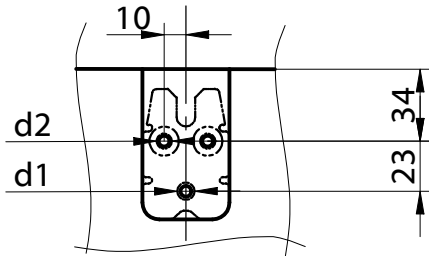

d1...Ø 5mm, 30mm tief vorbohren
d1...Ø 5mm, 30mm deep predrilling

d2...Ø 5mm, 10mm tief vorbohren
d2...Ø 5mm, 10mm deep predrilling

Bohrbild im Pfosten /
drilling template for post

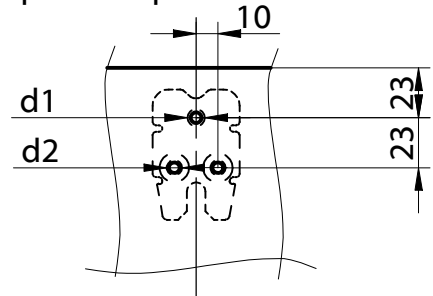

d1...Ø 12 mm, 20 mm tief vorbohren
d1...Ø 12 mm, 20 mm deep predrilling

d2...Ø 8 mm, 15 mm tief vorbohren
d2...Ø 8 mm, 15 mm deep predrilling

Schraubenbild im Riegel /
screw template for latch

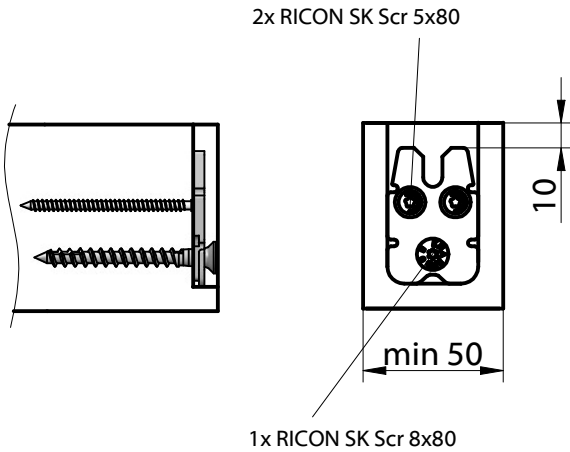

Schraubenbild im Pfosten /
screw template for post

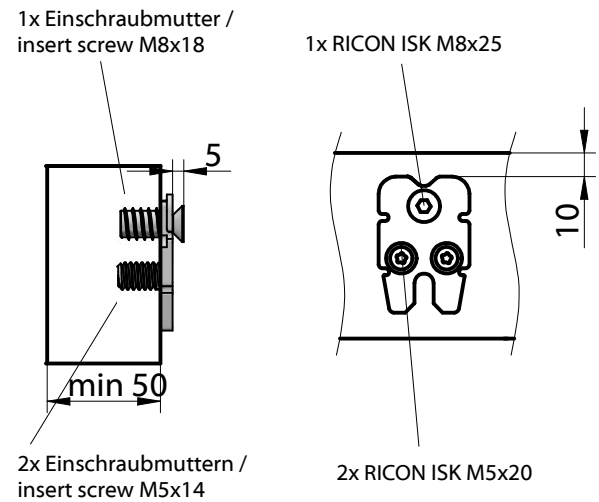

Einstellen der Schraube /
screw position adjustment
1.

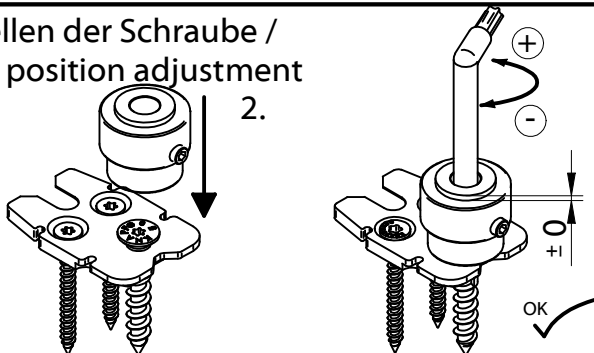

Sperrbügel einlegen /
assemble stirrup
1.

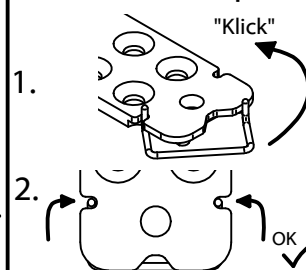

Sperrbügel lösen /
remove stirrup
1.

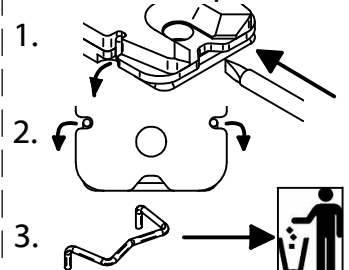

© KNAPP GmbH. Alle Maße in mm - Irrtümer, Druckfehler und Änderungen vorbehalten / all measures in mm - Errors excepted. VERSION 03 20.08.2010

RICON® 60/40



Haupt- Nebenträgerverbindung
 mit Bauzulassung (DE + EU)
main girder- joist connection
 with construction supervisory approval (DE + EU)

<p>RICON 60/40</p>	<p>RICON SK Scr 8x80</p>	<p>RICON ISK M 8x25, M8x20</p>
	<p>RICON SK Scr 8x50</p>	<p>RICON ISK M5x20</p>
	<p>RICON SK Scr 5x80</p>	<p>Verbundmutter / connecting nut M8x48, 53, 58, 78 M5x48, 53, 58, 78</p>
	<p>RICON SK Scr 5x50</p>	<p>RICON Einschraubmutter / insert M8x18 RICON Einschraubmutter / insert M5x14</p>
	<p>RICON Sperrbügel / stirrup</p>	

Einzel- und Doppelanschluss
single and double connection

Haupt-Nebenträgerverbindung
main girder - joist connection

Hauptträger Fräsbild /Milled edge main girder

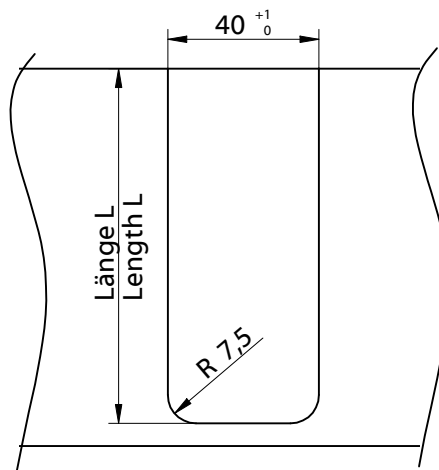
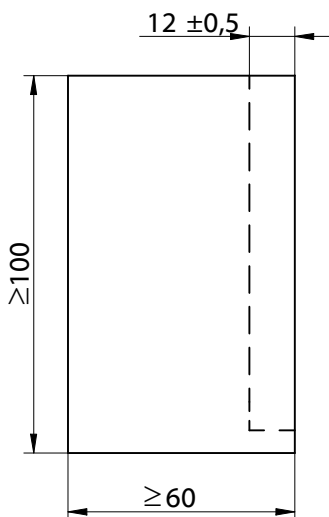

Ausfräslänge L aus dem Hauptträger in Abhängigkeit der Nebenträgerhöhe HN /
 Rebate length for main girder in reference of the height HN of the joist:

Höhe / Height HN [mm]	Länge/ Length L [mm]
100	90
120	110
140	130

© KNAPP GmbH. Alle Maße in mm - Irrtümer, Druckfehler und Änderungen vorbehalten / all measures in mm - Errors excepted. VERSION 03 20.08.2010

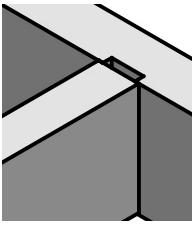

Montageanleitung/Construction Manual

RICON® 60/40 EA

Einzelanschluss
single connection

Haupt-Nebenträgerverbindung
main girder - joist connection

Art. Nr. K360

Bohrbild im Hauptträger /
drilling template for main girder

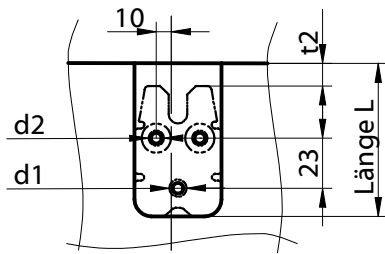

d1...Ø 5mm, 30mm tief vorbohren
d1...Ø 5mm, 30mm deep predrilling

d2...Ø 5mm, 10mm tief vorbohren
d2...Ø 5mm, 10mm deep predrilling

Bohrbild im Nebenträger /
drilling template for joist

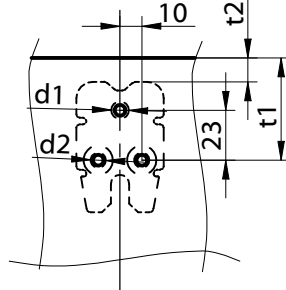

d1...Ø 5mm, 30mm tief vorbohren
d1...Ø 5mm, 30mm deep predrilling

d2...Ø 5mm, 10mm tief vorbohren
d2...Ø 5mm, 10mm deep predrilling

Einbohrmaße t1 und Abstandsmaß t2 in
Abhängigkeit der Nebenträgerhöhe HN/
Bore measure t1 and distance t2 for joist in
reference to the height HN of the joist

Höhe / Height HN [mm]	Abstand/ Distance t1 [mm]	Abstand/ Distance t2 [mm]
100	66	30
120	86	50
140	106	70

Schraubenbild im Hauptträger /
screw template for main girder

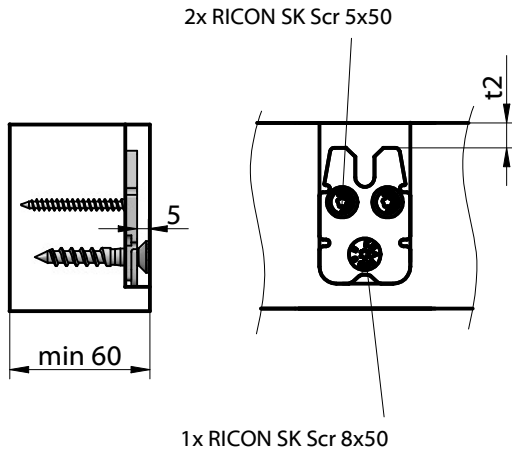

Schraubenbild im Nebenträger /
screw template for joist

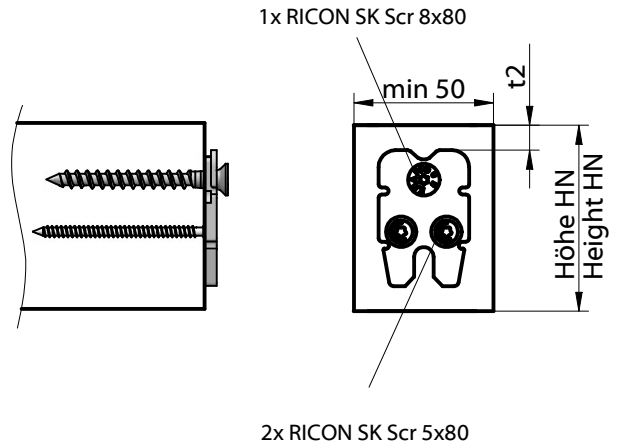

Einstellen der Schraube /
screw position adjustment

1.

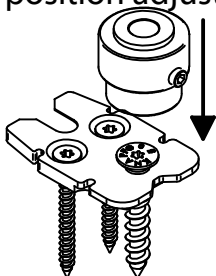

2.

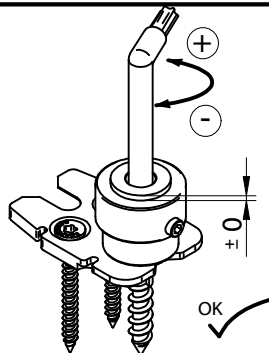

Sperrbügel einlegen /
assemble stirrup

1.

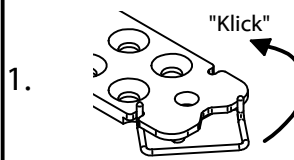

2.

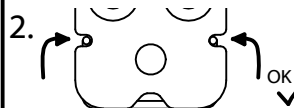

Sperrbügel lösen /
remove stirrup

1.

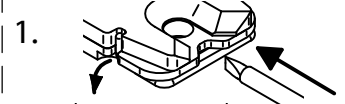

2.

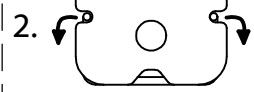

3.

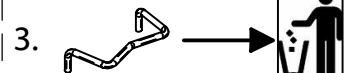

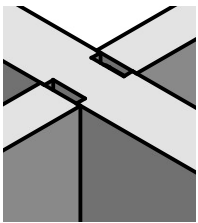

Montageanleitung/Construction Manual

RICON® 60/40 DA

Art. Nr. K160/48;
K160/58; K160/78

Doppelanschluss
double connection

Haupt-Nebenträger Verbindung
main girder - joist connection

Bohrbild im Hauptträger /
drilling template for main girder

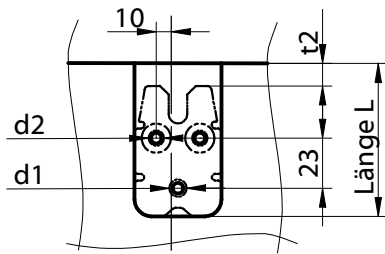

d1...Ø 10mm, Durchgangsloch
d1...Ø 10mm, throughhole

d2...Ø 8mm, Durchgangsloch
d2...Ø 8mm, throughhole

Bohrbild im Nebenträger /
drilling template for joist

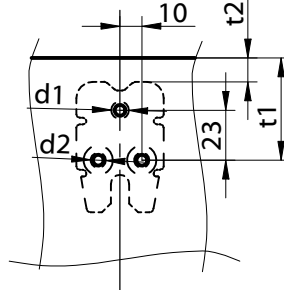

d1...Ø 5mm, 30mm tief vorbohren
d1...Ø 5mm, 30mm deep predrilling

d2...Ø 5mm, 10mm tief vorbohren
d2...Ø 5mm, 10mm deep predrilling

Einbohrmaße t1 und Abstandsmaß t2 in
Abhängigkeit der Nebenträgerhöhe HN/
Bore measure t1 and distance t2 for joist in
reference to the height HN of the joist

Höhe / Height HN [mm]	Abstand/ Distance t1 [mm]	Abstand/ Distance t2 [mm]
100	66	30
120	86	50
140	106	70

Schraubenbild im Hauptträger /
screw template for main girder

2x Verbundmutter
M5 x 48, 53, 58, 78

2x RICON ISK M5x20

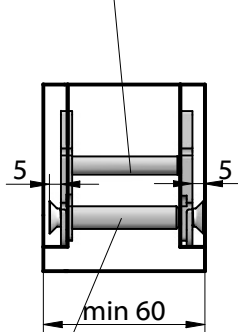

1x Verbundmutter
M8 x 36, 48, 53, 58, 78

1x RICON ISK M8x25

Hauptträger- stärke [mm]	Verbund- mutterlänge [mm]
60	36
80	53

Schraubenbild im Nebenträger /
screw template for joist

1x RICON SK Scr 8x80

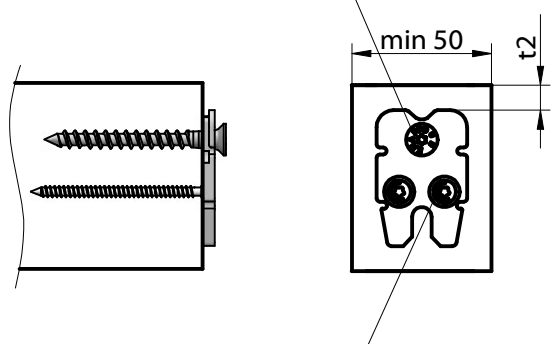

2x RICON SK Scr 5x80

Einstellen der Schraube /
screw position adjustment

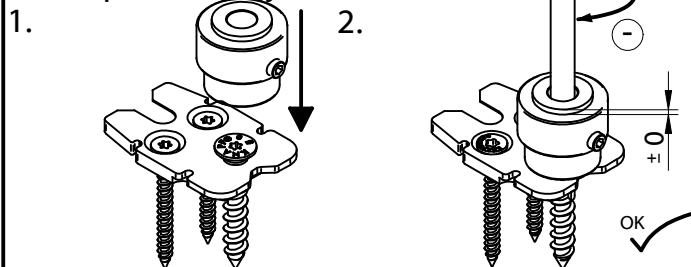

Sperrbügel einlegen /
assemble stirrup

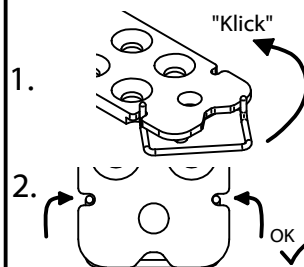

Sperrbügel lösen /
remove stirrup

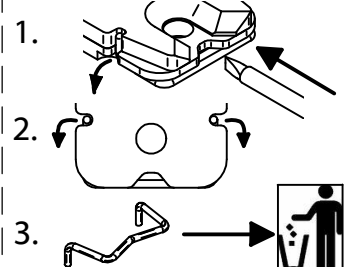

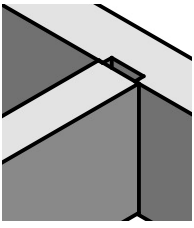

Montageanleitung/Construction Manual

RICON® 60/40 EAR

Art. Nr. K260

Einzelanschluss mit Einschraubmutter
single connection with insert screw

Haupt-Nebenträger Verbindung
main girder - joist connection

Bohrbild im Hauptträger /
 drilling template for main girder

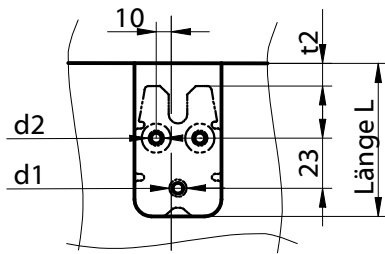

d1...Ø 12mm, 20mm tief vorbohren
 d1...Ø 12mm, 20mm deep predrilling

d2...Ø 8mm, 15mm tief vorbohren
 d2...Ø 8mm, 15mm deep predrilling

Bohrbild im Nebenträger /
 drilling template for joist

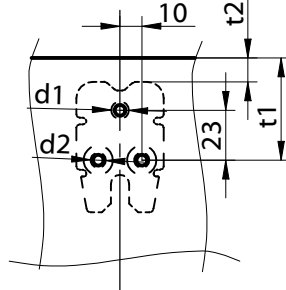

d1...Ø 5mm, 30mm tief vorbohren
 d1...Ø 5mm, 30mm deep predrilling

d2...Ø 5mm, 10mm tief vorbohren
 d2...Ø 5mm, 10mm deep predrilling

Einbohrmaße t1 und Abstandsmaß t2 in
 Abhängigkeit der Nebenträgerhöhe HN/
 Bore measure t1 and distance t2 for joist in
 reference to the height HN of the joist

Höhe / Height HN [mm]	Abstand/ Distance t1 [mm]	Abstand/ Distance t2 [mm]
100	66	30
120	86	50
140	106	70

Schraubenbild im Hauptträger /
 screw template for main girder

2x Einschraubmutter/
 insert screw M5x14

2x RICON ISK M5x20

1x Einschraubmutter/
 insert screw M8x18

1x RICON ISK M8x25

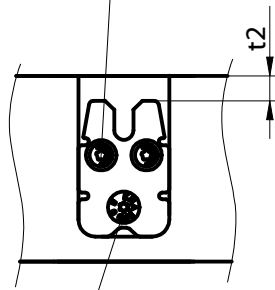
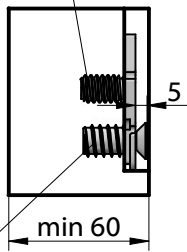

Schraubenbild im Nebenträger /
 screw template for joist

1x RICON SK Scr 8x80

2x RICON SK Scr 5x80

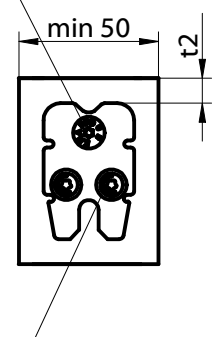
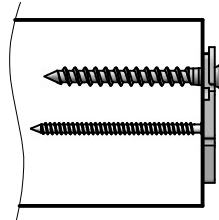

Einstellen der Schraube /
 screw position adjustment

1. 2.

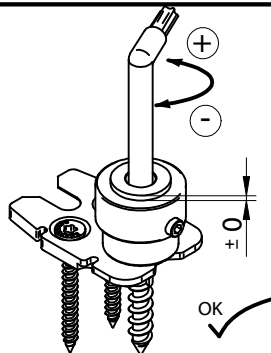
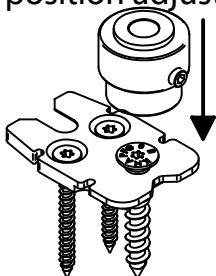

Sperrbügel einlegen /
 assemble stirrup

1. 2.

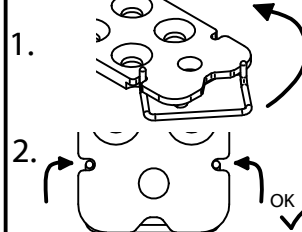

Sperrbügel lösen /
 remove stirrup

1. 2. 3.

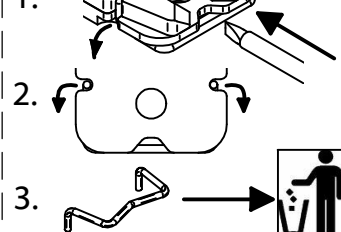

© KNAPP GmbH. Alle Maße in mm - Irrtümer, Druckfehler und Änderungen vorbehalten / all measures in mm - Errors excepted. VERSION 03 20.08.2010