

SECTION B-B
SCALE 3 : 1

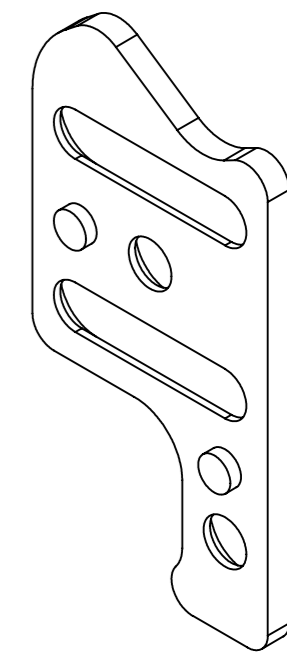
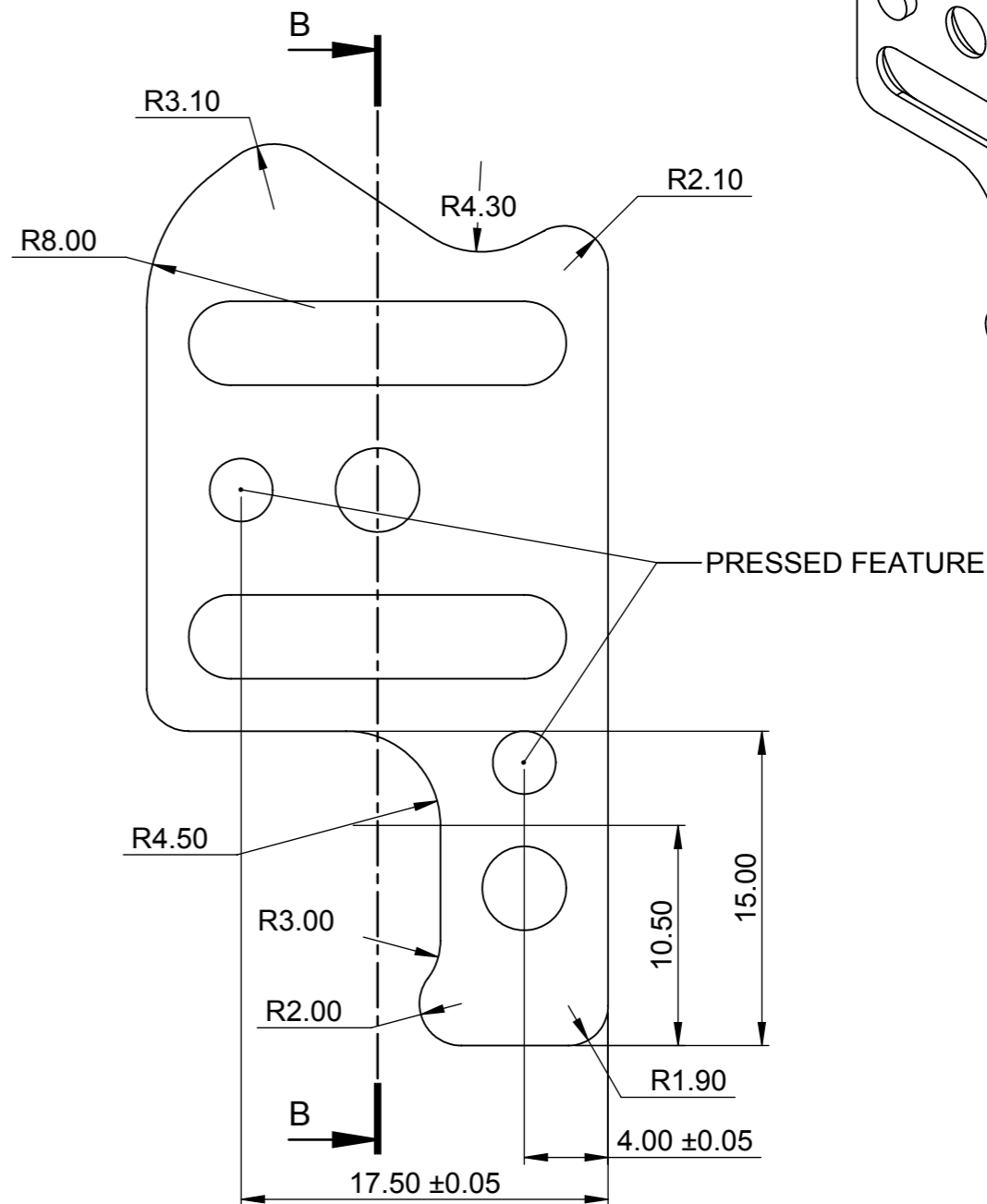

模具制造用图 ISSUED FOR TOOLING	
TO	TSA
DATE	01/11/2016
SIGN	I. SANGHA

DO NOT SCALE - IF IN DOUBT ASK	
○ DENOTES CRITICAL DIMENSION	
PROJECT CODE:	DL-070 (REFER TO SPECIFICATION)
MATERIAL:	Mild Steel CS4 1/2 HARD (REFER TO SPECIFICATION)
FINISH:	ZINC PLATE & PASS
VOLUME:	911.23
WEIGHT:	7.11

62.283.60

TITLE:	SYRINGE ECO-LOCK KEEP BOTTOM PLATE	
DRAWN BY:	IS	UNSPECIFIED TOL'S LIN ±0.10 ANG ±1.0°
DATE:	11/01/2016	
SCALE:	2:1	DRAWING No. 21496
SPEC CODE:	REV	
	04	

STRAIGHT ROAD, SHORT HEATH
 WILLENHALL, WEST MIDLANDS, WV12 5RA
 TEL: 01922 490049 FAX: 01922 490047

04	CHAMFER ADDED, TOOLING ISSUE	01/11/2016	IS
03	TOLERANCE ADDED	08/08/2016	IS
02	3.0 WAS 2.0, TOOLING ISSUE	30/06/2016	IS
01	TOOLING ISSUE	29/06/2016	IS
REV	MODIFICATION	DATE	BY