

# LED RGB Steuerung

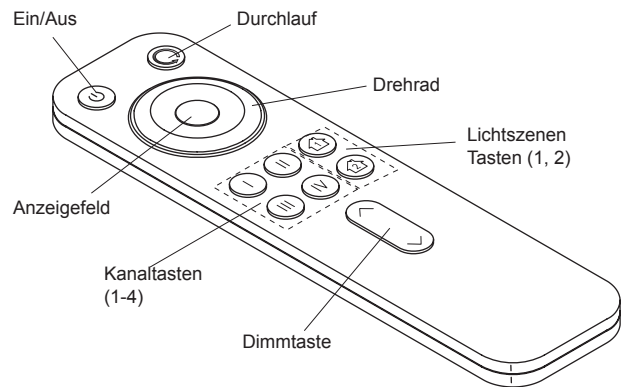

## TASTENBELEGUNG

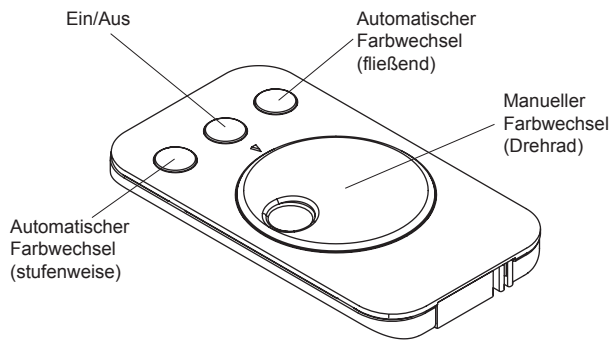

## A1 ANLERNEN

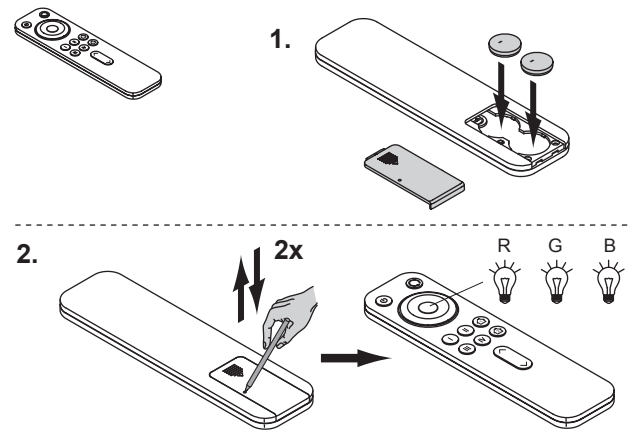
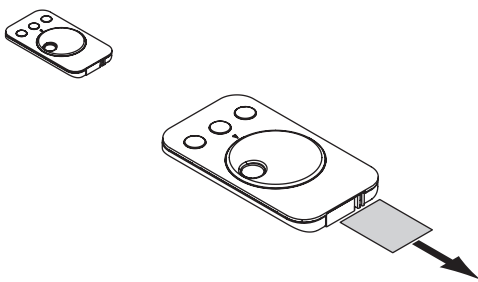

## A2

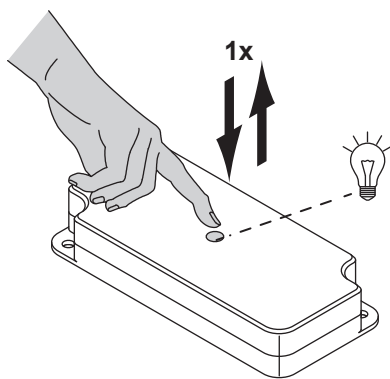

## A3

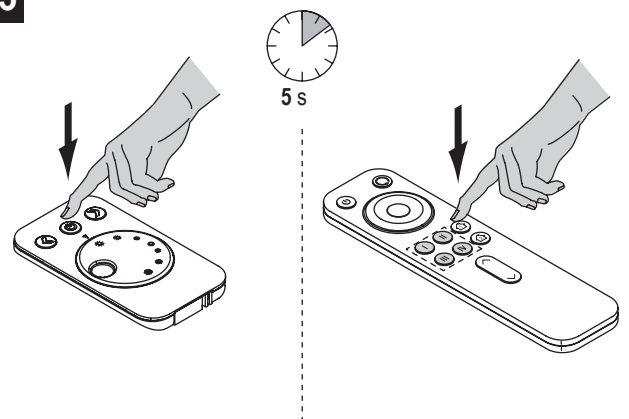

## A4

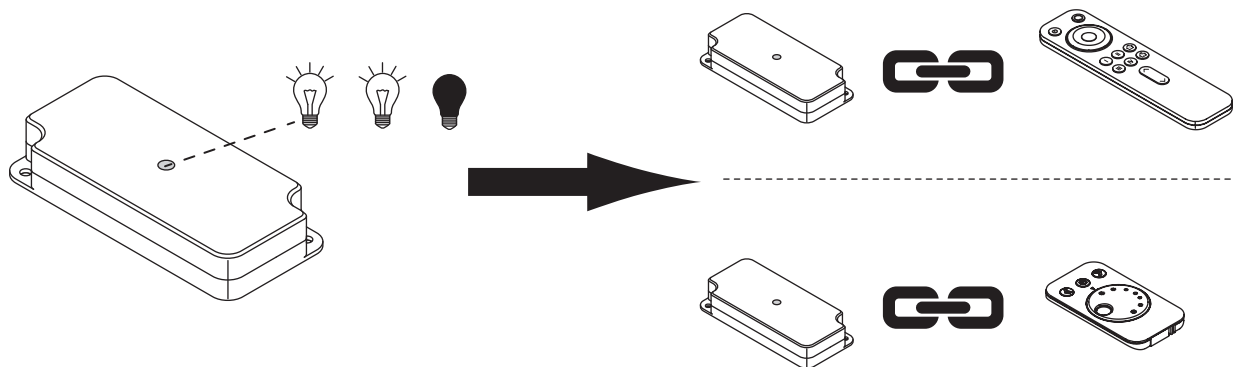

### B1 MASTER- / SLAVE-MODUS

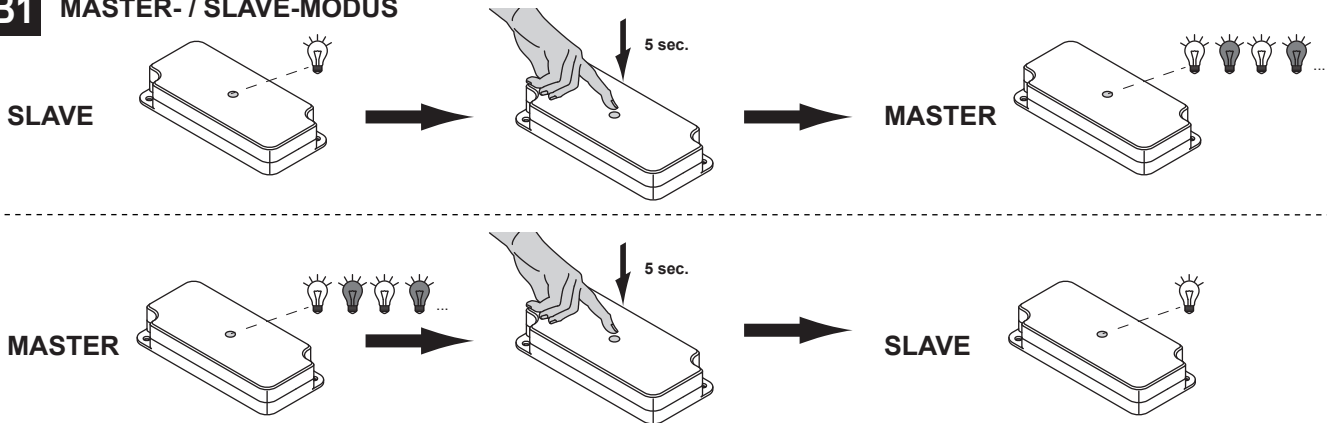

### B2

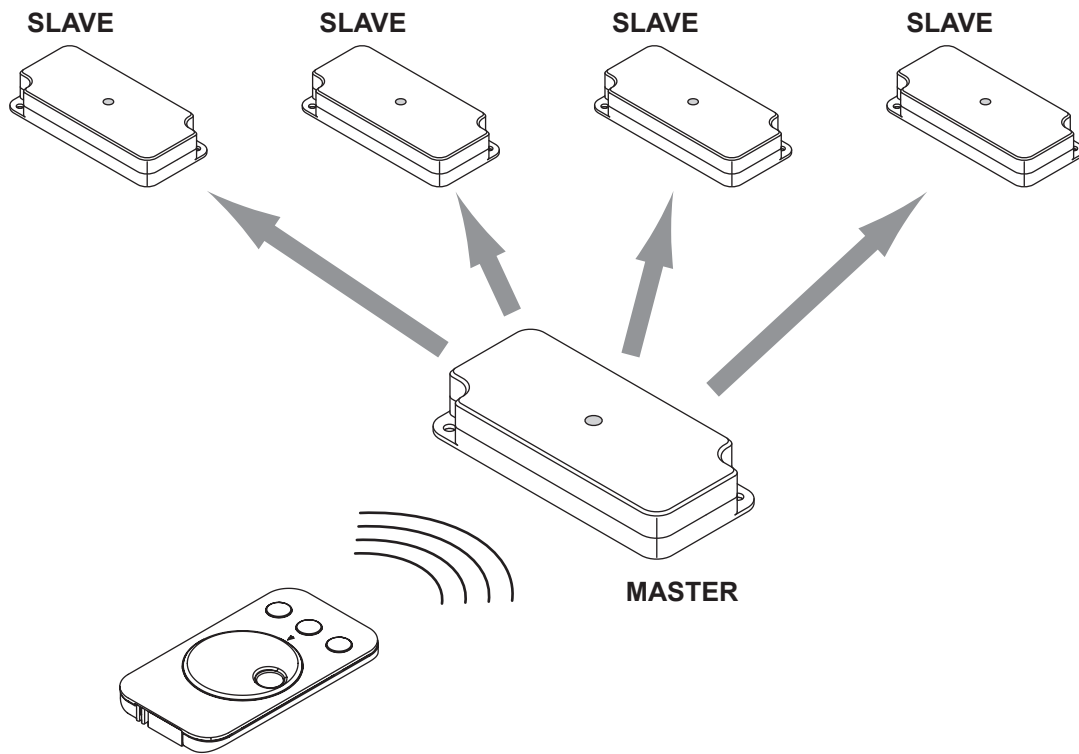

### Erweiterte Funktionen

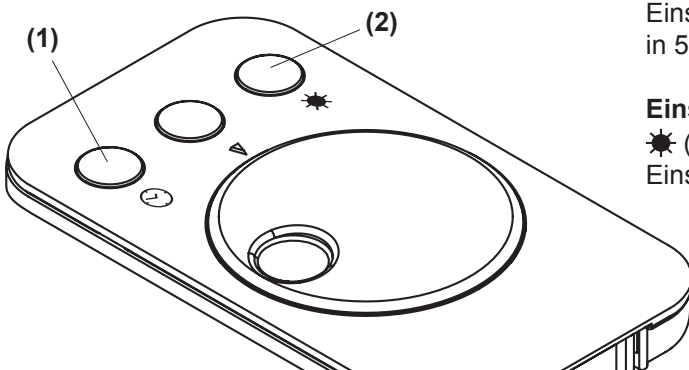

#### Geschwindigkeit des Farbwechsels

🕒 (1) gedrückt halten + Drehrad betätigen zur Einstellung der Geschwindigkeit des Farbwechsels in 5 Stufen

#### Einstellen der Helligkeit

★ (2) gedrückt halten - Drehrad betätigen zur Einstellung der Helligkeit in 5 Stufen.