

# Quick Start

## Leica DISTO™ X310

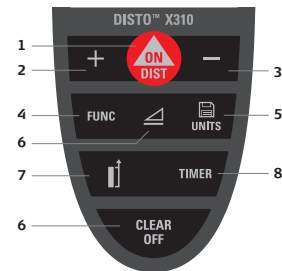

- 1 ON/DIST (on/measure)
- 2 Add
- 3 Subtract
- 4 Functions
- 5 Memory/Unit
- 6 Smart Horizontal Mode™
- 7 Measuring reference
- 8 Timer
- 9 Clear/Off

- when it has to be **right**

**Leica**  
Geosystems

### Keylock ON

**CLEAR OFF** **2 sec.**

KEY  
LOCK

On

### Keylock OFF

PRESS  
MI NUS

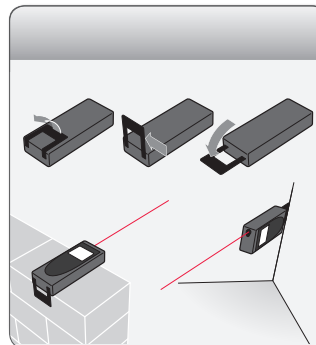

### Key Combinations

+ **2 sec.**

+ **2 sec.**

+ **2 sec.**

**change tilt units**

**2 sec.**

**change units**

### Reference

**1x**

**2 sec.**

**permanent**

### Tripod

**2x**

**3x (default)**

### UNITS

**1x**

**history (1-20)**

**1 ... 20**

**20 ... 1**

**2 sec.**

**use for calculations**

+ **2 sec.**

**delete history**

### 1x

### 2x



**FUNC** 1x

→ **FUNC** 2 sec.

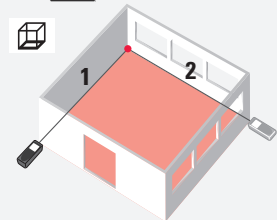

**FUNC** 3x

→ **FUNC** 2 sec.

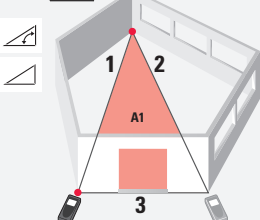

**FUNC** 5x

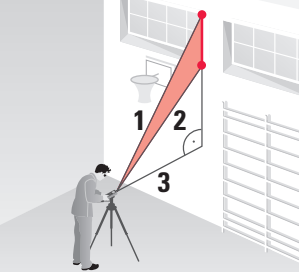

**FUNC** 2x

→ **FUNC** 2 sec.

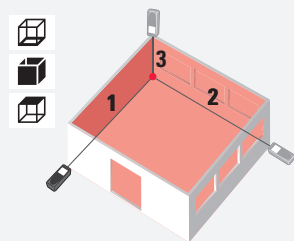

**FUNC** 4x

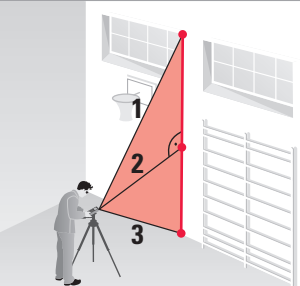

**FUNC** 6x

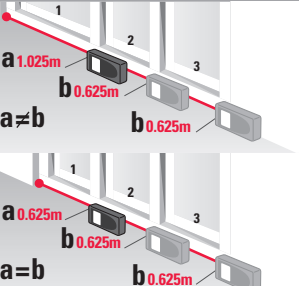

Laser class 2 in acc. to IEC 60825-1

[www.disto.com](http://www.disto.com)



SAP. No. 788 481

